



5 Coachella Crescent Upper Coomera QLD

4  2  2 

Located in the popular Highland Reserve Estate, this well-presented home offers space, comfort, and convenience for everyday family living.

The home features multiple living areas including a separate lounge, dining space, and media room-perfect for families needing extra room to spread out.

The kitchen is well-appointed with stone benchtops, gas cooktop, dishwasher, and plenty of storage, overlooking the main living and dining area.

The tiled family and dining area flows out to a large covered deck with ceiling fans and lighting-ideal for entertaining or relaxing outdoors.

Price : \$870 pw
Building Size : 150 sqm
Land Size : 579 sqm
View : <https://www.hinterlandrealty.com/86878>
 18



Lauren Johnson
07 5578 2311



Chloe Flack
07 5578 2311

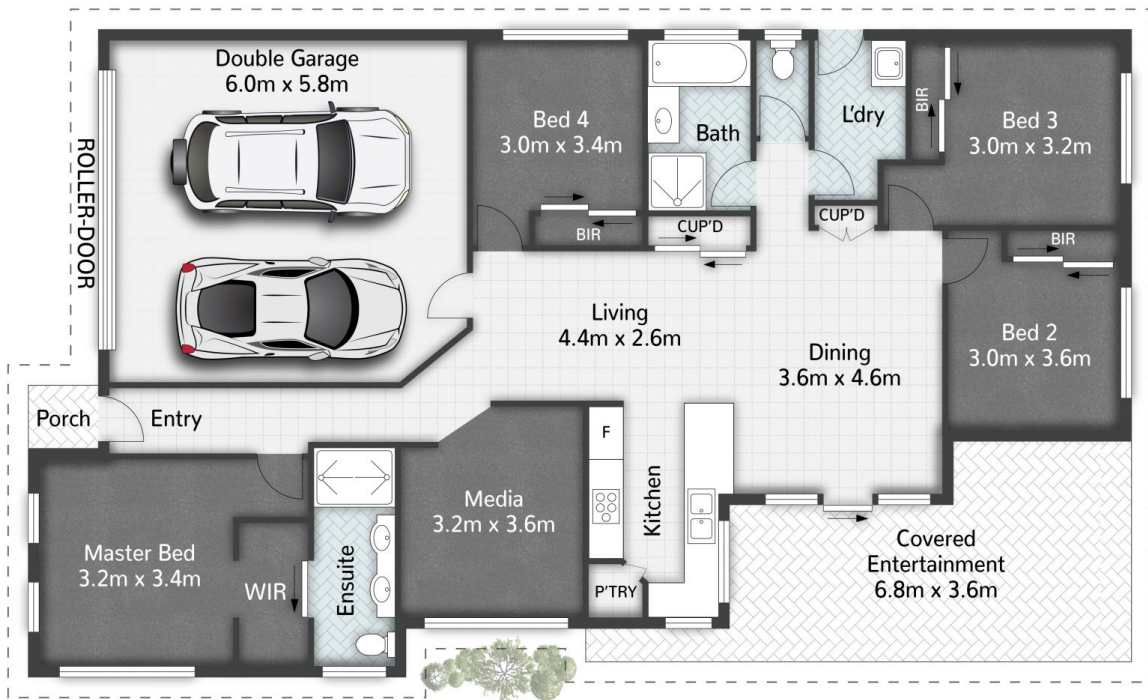

Plans are shown for marketing purposes only. All dimensions are approximate; they are subject to errors and inaccuracies and no liability will be accepted.